

Hose-32 - Installation Guide



Thank you for purchasing one of our Power Steering Hoses to fit - **Ford Falcon FG Series 2 (6 Cyl. Engine)**

To fit this new hose you need to remove all of the factory hoses, brackets and rubber mountings off the old original hose and swap them over onto our New Hose. Photos below show how to undo the folded steel brackets so you can replace the hose assembly.



Using a screwdriver gently fold the steel tag open on the brackets.
Take-care not to damage tag.



With the tag unclipped gently open the outer steel bracket and remove.
Take-care not to over bend the bracket.

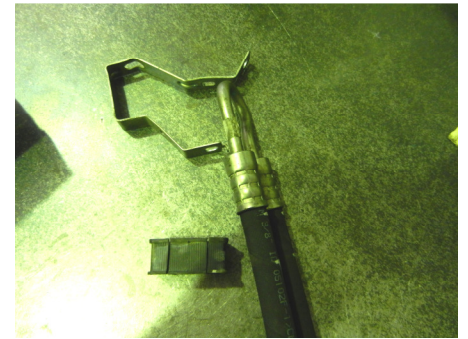
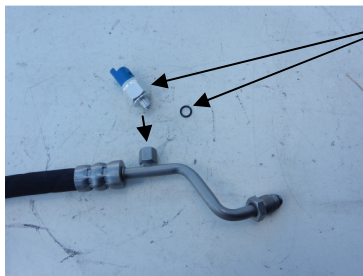

Photo above shows outer steel bracket and rubber support removed from old original hose.
Install all brackets & rubbers onto new hose.

This Hose comes with New O-Ring's installed on each end of the Hose ready to fit and we also supply 2 New O-Rings for the Idle-Up Switch and the return Pipe.

The Larger O-Ring (8mm ID x 1.5) supplied is to be replaced on Idle-Up Switch (to be removed from old Hose and re-fitted to the new hose) see photos below.



The Larger O-Ring is for the Idle-Up Switch

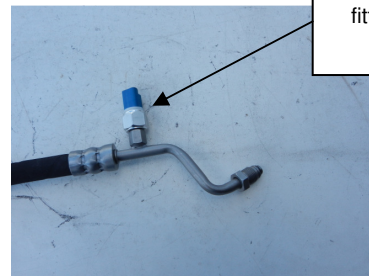

Original Idle-Up Switch fitted to New Hose with new O-Ring Fitted.

The Smaller O-Ring (6mm ID x 2) is supplied to be replaced on the original Return Pipe on the end that bolts onto the steering rack housing. (Low Pressure Hose) see photos below.

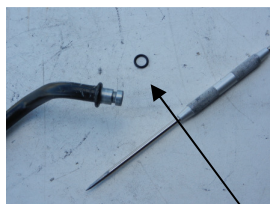

New O-Ring fitted to Original Return Hose ready for fitting to steering rack housing.

Use a scriber or small screwdriver and remove the old O-Ring and replace it with the new O-Ring Supplied. As per Photos above.

These new O-Rings need to be installed correctly on the Idle-Up Switch and the Original Return Hose to make sure that your new hose gives a long service life.